

PLC SERIES CONNECTOR



The **1/4" flow PLC Series** is proven worldwide in thousands of applications and offers the widest selection of sizes and configurations. PLC couplings are injection molded from acetal thermoplastic and are resistant to most mild chemical solutions. One-hand connection/disconnection, plus integral terminations make the PLC Series the choice for ease of use and manufacture.

FEATURES

CPC thumb latch

Integral terminations

Clicks when connected

Compatible

BENEFITS

One-hand connection and disconnection

Fewer leak points, shorter assemblies, faster installations

Assurance of a reliable connection

Mates with LC and PLC12 Series couplings

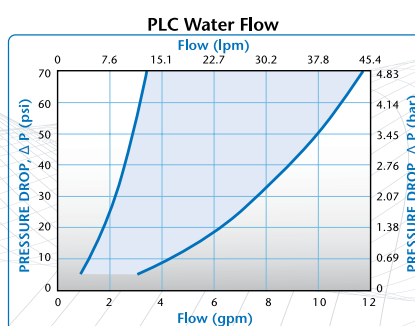
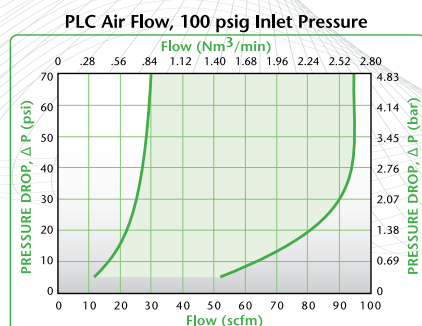

Specifications

PRESSURE:

Vacuum to 120 psi, 8.3 bar

TEMPERATURE:

-40°F to 180°F (-40°C to 82°C)

MATERIALS:

Main components and valves: Acetal

Thumb latch: Stainless steel

Valve spring: 316 stainless steel

External springs and pin: Stainless steel

O-rings: Buna-N

COLOR: Natural white, others available

TUBING SIZES:

1/4" to 3/8" ID, 6.4mm to 9.5mm ID

JG® TUBING SPECIFICATIONS:

Tube tolerances: 1/4" OD, +0.001/-0.004 | 3/8" OD, +0.001/-0.004

Tube Types: Plastic tube: Polyethylene, nylon, polyurethane. For soft or thin wall tubing with JG® terminations, tube supports are recommended.

Metal tube: Brass, copper and mild steel

Also available in NSF listed versions, please visit our website for part number information.



These graphs are intended to give you a general idea of the performance capabilities of each product line. The shaded area of each graph represents the operating range of the product family, i.e., upper and lower values are shown. Therefore, depending on the exact coupling configurations selected, you can reasonably expect values to fall within the shaded area.

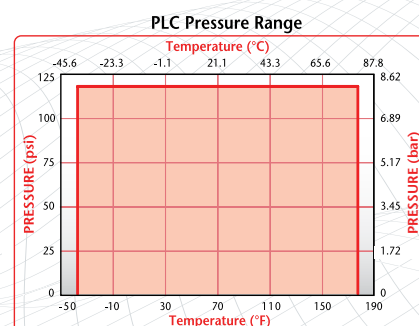

Decoding Coupling Options

Often times, it can be an overwhelming task to decipher which coupling best fits your application needs. The chart below helps to decode popular CPC couplings.

1/4" FLOW OPTIONS	PRIMARY MATERIAL	O-RING	APPLICATION BENEFITS
PLC	Acetal	Buna-N	General purpose plastic connector with metal latch
PLC12	Polypropylene	EPDM	Expanded chemical compatibility
LC	Chrome-Plated Brass	Buna-N	Higher operating temperature and pressure
APC	Acetal	Buna-N	Plastic thumb latch
BREAKAWAY®	Acetal	Buna-N	Breakaway latch
NS4	Glass-filled polypropylene	EPDM	Drybreak, non-spill connect and disconnect, even under pressure

For further information please contact CPC Customer Service at 1-800-444-2474 or 651-645-0091.

Liquid Flow Rate Information for Couplings

The chart below shows the flow rate for CPC couplings. Each coupling was tested with water at 70°F (21°C). To determine flow rates for specific coupling configurations use the formula at the right.

$$Q = C_v \sqrt{\frac{\Delta P}{S}}$$

Q = Flow rate in gallons per minute
C_v = Average coefficient across various flow rates (see chart)
ΔP = Pressure drop across coupling (psi)
S = Specific gravity of liquid

C_v VALUES FOR 1/4" FLOW PLC COUPLINGS

BODIES	INSERTS	PLC 20004	PLCD 20004	PLC 20006	PLCD 20006	PLC 22004	PLCD 22004	PLC 22006	PLCD 22006	PLC 24004	PLCD 24004	PLC 24006	PLCD 24006	PLC 26004
PLC10004		.40	.36	1.05	.58	.83	.56	1.40	.82	1.40	.75	1.40	.77	.83
PLCD10004		.36	.31	.73	.48	.66	.41	.82	.50	.80	.45	.77	.45	.81
PLC10006		.40	.36	1.05	.60	.83	.56	1.40	.81	1.40	.76	1.40	.76	.83
PLCD10006		.37	.31	.81	.47	.70	.43	1.02	.51	.98	.46	.99	.48	.98
PLC12006		.38	.36	.84	.63	.74	.56	1.14	.75	1.14	.70	1.14	.72	.74
PLCD12006		.38	.33	.78	.49	.68	.44	.84	.49	.81	.43	.82	.44	.81
PLC16004		.38	.37	.87	.54	.95	.51	1.00	.70	.95	.64	1.00	.66	.95
PLCD16004		.37	.31	.61	.44	.57	.41	.78	.44	.78	.43	.75	.46	.78
PLC16006		.38	.37	1.00	.57	.95	.53	1.40	.80	1.40	.71	1.40	.73	1.40
PLCD16006		.38	.32	.71	.49	.63	.42	.89	.51	.96	.45	.92	.49	.97

PLC DIMENSIONS

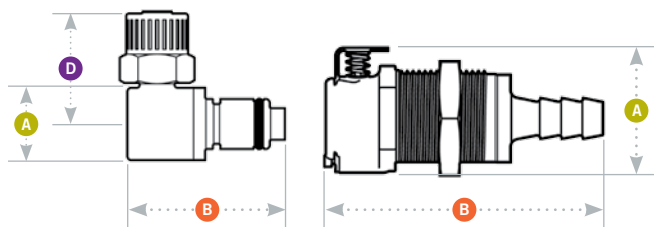

- A = Height/Diameter
- B = Total Length
- D = Elbow Radial Length

Panel Dimensions

	PANEL OPENING	PANEL THICKNESS MAX.-MIN.	PANEL NUT HEX	PANEL NUT THREAD
COUPLING BODIES	see drawing	.50 - .05	13/16	11/16-24UNEF
COUPLING INSERTS	see drawing	.30 - .05	13/16	11/16-24UNEF

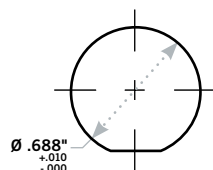

Coupling Bodies • ACETAL



TERMINATION IN-LINE PIPE THREAD

PANEL MOUNT FERRULELESS POLYTUBE FITTING, PTF†

PANEL MOUNT HOSE BARB

PANEL MOUNT JG® PUSH-TO- CONNECT

IN-LINE FERRULELESS POLYTUBE FITTING, PTF†

IN-LINE HOSE BARB

IN-LINE JG® PUSH-TO- CONNECT

TUBING/THREAD SIZE METRIC EQ.

1/4" NPT
1/4" BSPT
3/8" NPT
3/8" BSPT

1/4" OD, .17" ID 6.4mm OD, 4.3mm ID
8.0mm OD, 6.0mm ID
3/8" OD, .25" ID 9.5mm OD, 6.4mm ID
10.0mm OD, 8.0mm ID

1/4" ID 6.4mm ID
5/16" ID 7.9mm ID
3/8" ID 9.5mm ID

1/4" OD 6.4mm OD

1/4" OD, .17" ID 6.4mm OD, 4.3mm ID
8.0mm OD, 6.0mm ID
3/8" OD, .25" ID 9.5mm OD, 6.4mm ID
10.0mm OD, 8.0mm ID

1/4" ID 6.4mm ID
5/16" ID 7.9mm ID
3/8" ID 9.5mm ID

1/4" OD 6.4mm OD
3/8" OD 9.5mm OD
(See page 162 for JG accessories)

STRAIGHT THRU

PLC10004
PLC10004BSPT
PLC10006
PLC10006BSPT

PLC12004
PLC120M8
PLC12006
PLC120M10

PLC16004
PLC16005
PLC16006

PLC11004

PLC13004
PLC130M8
PLC13006
PLC130M10

PLC17004
PLC17005
PLC17006

PLC14004
PLC14006

SHUTOFF

PLCD10004
PLCD10004BSPT
PLCD10006
PLCD10006BSPT

PLCD12004
PLCD120M8
PLCD12006
PLCD120M10

PLCD16004
PLCD16005
PLCD16006

PLCD11004

PLCD13004
PLCD130M8
PLCD13006
PLCD130M10

PLCD17004
PLCD17005
PLCD17006

PLCD14004
PLCD14006

A	B
.90	1.17
.90	1.15
.90	1.15
.90	1.15
.88	1.87
.88	1.95
.88	1.95
.88	1.95
.88	1.95
.88	1.95
.94	1.82
.94	1.95
.94	1.95
.94	1.95
.94	1.80 / 1.95
.94	1.95
.94	1.80 / 1.95
.94	1.95
.94	2.09

All measurements are in inches (millimeters) unless otherwise noted. Tubing must meet stated inside and outside diameters.
†NOTE: CPC's Ferruleless Polytube Fitting terminations do not require ferrules to achieve a secure connection, which makes them easier to use and reuse. PTF fittings are designed for semi-rigid tubing, i.e., polyethylene, nylon, polyurethane, etc. NOTE: JG is a registered trademark of John Guest USA, Inc.

Coupling Inserts • ACETAL



TERMINATION IN-LINE PIPE THREAD

PANEL MOUNT FERRULELESS POLYTUBE FITTING, PTF†

PANEL MOUNT HOSE BARB

PANEL MOUNT JG® PUSH-TO- CONNECT

IN-LINE FERRULELESS POLYTUBE FITTING, PTF†

IN-LINE HOSE BARB

IN-LINE JG® PUSH-TO- CONNECT

ELBOW FERRULELESS POLYTUBE FITTING, PTF†

ELBOW HOSE BARB

TUBING/THREAD SIZE METRIC EQ.

STRAIGHT THRU

SHUTOFF

A

B

D

1/4" NPT			PLC24004	PLCD24004	.72	1.25/1.66	
1/4" BSPT			PLC24004BSPT	PLCD24004BSPT	.72	1.53/1.66	
3/8" NPT			PLC24006	PLCD24006	.87	1.25/1.63	
3/8" BSPT			PLC24006BSPT	PLCD24006BSPT	.87	1.51/1.63	
1/4" OD, .17" ID	6.4mm OD, 4.3mm ID		PLC40004	PLCD40004	.94	1.78/1.91	
	8.0mm OD, 6.0mm ID		PLC400M8	PLCD400M8	.94	1.91/2.03	
3/8" OD, .25" ID	9.5mm OD, 6.4mm ID		PLC40006	PLCD40006	.94	1.91/2.05	
	10.0mm OD, 8.0mm ID		PLC400M10	PLCD400M10	.94	1.91/2.05	
1/4" ID	6.4mm ID		PLC42004	PLCD42004	.94	1.91/2.05	
5/16" ID	7.9mm ID		PLC42005	PLCD42005	.94	1.91/2.05	
3/8" ID	9.5mm ID		PLC42006	PLCD42006	.94	1.91/2.05	
1/4" OD	6.4mm OD		PLC41004	PLCD41004	.94	1.91/2.05	
1/4" OD, .17" ID	6.4mm OD, 4.3mm ID		PLC20004	PLCD20004	.72	1.25/1.88	
	8.0mm OD, 6.0mm ID		PLC200M8	PLCD200M8	.72	1.38/1.82	
3/8" OD, .25" ID	9.5mm OD, 6.4mm ID		PLC20006	PLCD20006	.72	1.38/1.82	
	10.0mm OD, 8.0mm ID		PLC200M10	PLCD200M10	.72	1.38/1.82	
1/4" ID	6.4mm ID		PLC22004	PLCD22004	.62	1.35/1.99	
5/16" ID	7.9mm ID		PLC22005	PLCD22005	.62	1.35/1.99	
3/8" ID	9.5mm ID		PLC22006	PLCD22006	.62	1.36/1.81	
1/4" OD	6.4mm OD		PLC29004	PLCD29004	.63	1.35/1.95	
3/8" OD	9.5mm OD		PLC29006	PLCD29006	.78	1.51/2.11	
3/8" OD, .25" ID	9.5mm OD, 6.4mm ID		PLC21006	PLCD21006	.61/.62	1.22/1.35	.85/.96
1/4" ID	6.4mm ID		PLC23004	PLCD23004	.67/.63	1.10/1.28	.85/.96
3/8" ID	9.5mm ID		PLC23006	PLCD23006	.67/.63	1.25/1.28	.90/.96

All measurements are in inches (millimeters) unless otherwise noted. Tubing must meet stated inside and outside diameters. Couplings are pictured with valves unless otherwise noted.

†NOTE: CPC's Ferruleless Polytube Fitting terminations do not require ferrules to achieve a secure connection, which makes them easier to use and reuse. PTF fittings are designed for semi-rigid tubing, i.e., polyethylene, nylon, polyurethane, etc. NOTE: JG is a registered trademark of JG®.

美国CPC_Colder Products Company快速接头和连接器
授权西北代理商联系方式

西安嘉岳自动化技术有限公司 Garye Automation Company

地址：西安市未央区未央大道138-1号中登大厦A座十二层

电话：029 - 8647 4991 邮编：710016

传真：029 - 8647 3942 公司QQ:3180038393

手机：182 9256 1696

E-mail：sales@garye.cn

Web：http://www.garye.cn