

# TENTUBE SERIES CONNECTOR



## Specifications ● ● ●

### PRESSURE:

Vacuum to 100 psi, 6.9 bar per line

### TEMPERATURE:

**Acetal fitting inserts:**  
-40°F to 180°F (-40°C to 82°C)

**Polypropylene fitting inserts:**  
32°F to 180°F (0°C to 82°C)

### MATERIALS:

**Main components:** Nylon

**Valves:** Acetal

**Valve springs:** 316 stainless steel

**Fitting inserts:** Acetal or polypropylene

**O-rings:** Buna-N with acetal  
or EPDM with polypropylene

**Panel mount adapter:** Acetal

**Tube shroud:** Acetal

### COLOR:

**Main components:**

Black with red locking latch

**Tube shroud:** Black

**Panel mount adapter:** Black

### TUBING SIZES:

1/16" to 1/8" ID, 1.6mm to 3.2mm ID

These graphs are intended to give you a general idea of the performance capabilities of each product line. The shaded area of each graph represents the operating range of the product family, i.e., upper and lower values are shown. Therefore, depending on the exact coupling configurations selected, you can reasonably expect values to fall within the shaded area.

**The Tentube™ coupling** provides one easy-to-use quick disconnect for up to ten separate fluid lines. The Tentube is available with valves on the body side in panel mount or in-line configurations for maximum design flexibility. The Tentube can connect and disconnect up to ten lines with the use of a simple slide latch. Tubing orientation is ensured by keying the coupling body and insert. Different fluids and tubing sizes can be accommodated by using acetal or polypropylene inserts in three popular sizes.

## FEATURES

Ten line connection

Separate flow paths

Insert is keyed to body

Acetal or polypropylene inserts

## BENEFITS

Fast, efficient operation

Pressure and/or vacuum in one coupling

Ensures correct line orientation

Maximize design flexibility

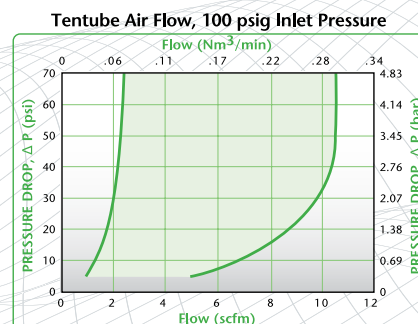
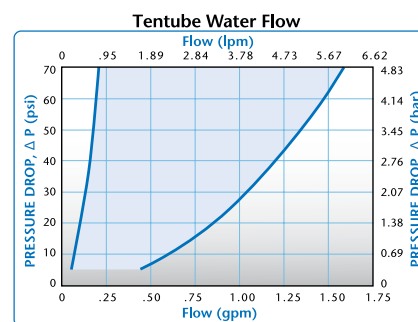

# TENTUBE DIMENSIONS

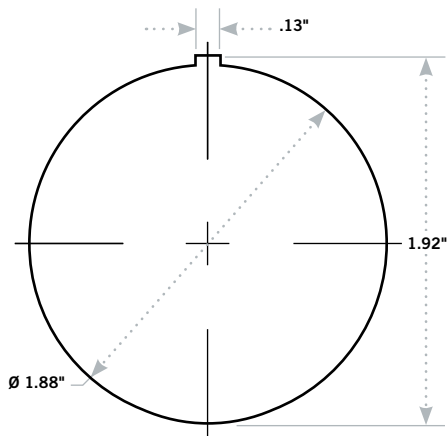

## Panel Dimensions

	PANEL OPENING	PANEL THICKNESS MAX.-MIN.
COUPLING BODIES	see drawing	.44- .06

## Fitting Bodies • ACETAL/POLYPROPYLENE



### TERMINATION COMPLETE COUPLING SET

### COUPLING BODY WITH FEMALE FITTING BODIES

### COUPLING INSERT WITH MALE FITTING INSERTS

TUBING SIZE	METRIC EQ.	ACETAL STRAIGHT THRU	ACETAL SHUTOFF	POLYPROPYLENE STRAIGHT THRU
1/16" ID	1.6mm ID	TT1001	TTD1001	TT100112
	3.0mm ID	TT10M3	TTD10M3	
1/8" ID	3.2mm ID	TT1002	TTD1002	TT100212
1/16" ID	1.6mm ID	TFB1001	TFBD1001	TFB100112
	3.0mm ID	TFB10M3	TFBD10M3	
1/8" ID	3.2mm ID	TFB1002	TFBD1002	TFB100212
Without fitting bodies		TFB10		
1/16" ID	1.6mm ID	TMB1001		TMB100112
	3.0mm ID	TMB10M3		
1/8" ID	3.2mm ID	TMB1002		TMB100212
Without fitting inserts		TMB10		

## Fitting Inserts • ACETAL/POLYPROPYLENE



### TERMINATION IN-LINE PIPE THREAD

### IN-LINE PIPE THREAD (FEMALE)

TUBING SIZE	METRIC EQ.	ACETAL STRAIGHT THRU	ACETAL SHUTOFF	POLYPROPYLENE STRAIGHT THRU
1/16" ID	1.6mm ID	TMF01		TMF0112
	3.0mm ID	TMFM3		
1/8" ID	3.2mm ID	TMF02		TMF0212
1/16" ID	1.6mm ID	TFF01	TFFD01	TFF0112
	3.0mm ID	TFFM3	TFFDM3	
1/8" ID	3.2mm ID	TFF02	TFFD02	TFF0212

Note: Acetal bodies and inserts are also available in white. To order, add MWHT to the end of the part number.

## Accessories



### DESCRIPTION

**TUBE SHROUD:** snaps into either half

### PART NO.

TS10

**PANEL MOUNT ADAPTER & NUT:** 7/16" max. panel thickness; requires 1.875" diameter hole

TPM10

All measurements are in inches (millimeters) unless otherwise noted. Tubing must meet stated inside and outside diameters. Couplings are pictured with valves unless otherwise noted.

Note: Use TMF and TFF inserts and bodies for custom designed assemblies.