



MINI HYBRID

The Mini Hybrid from Colder

integrates air lines and electronics into a compact, single connection point for remote tools on medical devices and equipment, reducing misconnections and enhancing patient therapy outcomes. Based on Colder's unique Hybrid Connector technology, the valved Mini Hybrid has a smaller form factor and is ideal for use in low-pressure applications where ease of use and ergonomics are important. This groundbreaking connector technology eliminates the need for multiple connections and allows clinicians or therapy patients to quickly and easily change or replace modular tools, umbilicals or hand pieces that require power, signal and gases.

Features

Single connection point for air and power connections between a device and its controller

Easy-to-use breakaway design

Valve on panel mount side

Turnkey solution

Off-the-shelf assembly

Custom options available

Benefits

Increases safety and makes systems more user friendly

Quick, automatic disconnect

Prevents loss of pressure upon disconnect

Reduces multiple components

Minimizes engineering design and manufacturing effort

Meets your unique requirements



from complex to simple



BREAKAWAY DESIGN
Disconnects when pull force is applied without pressing a latch, allowing users to make a clean, fast break.

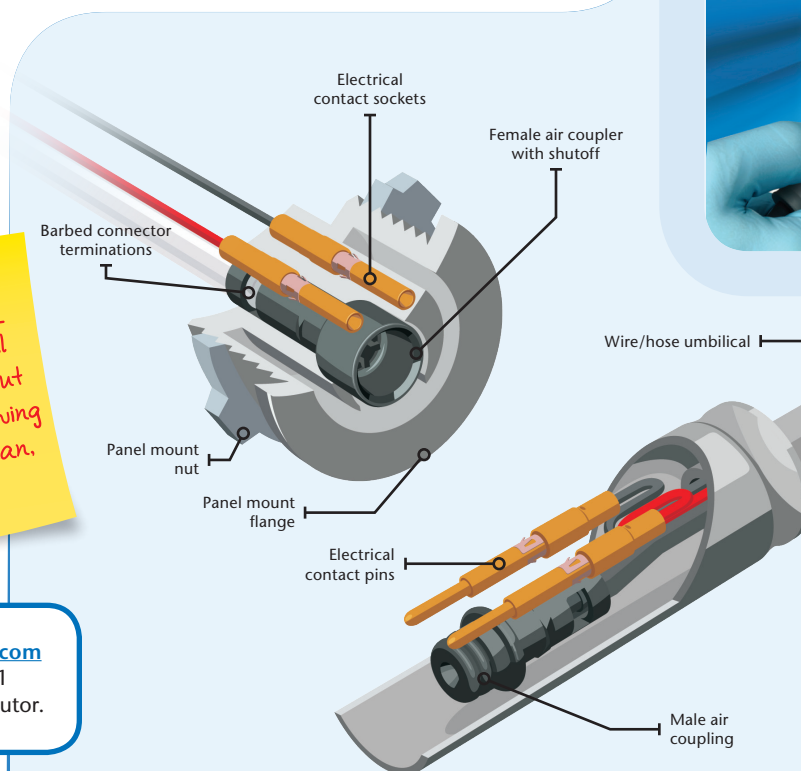

Visit us at www.colder.com
or call 651-645-0091
to find your local distributor.



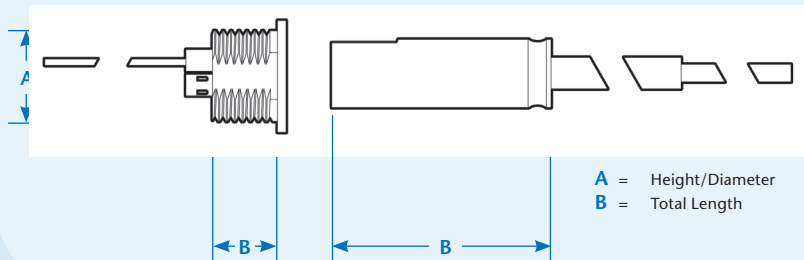

Product Dimensions

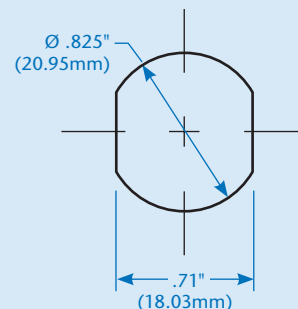

Connector Specifications

Pressure: Vacuum to 25 psi, 1.7 bar

Temperature: 40°F to 80°F
(4°C to 26°C)

Materials:

External coupler components: PET

Air coupler components: Acetal

Springs: Stainless steel

Panel Mount Nut: Zinc-plated steel

Electrical contacts: Gold-plated brass

Air line: PVC

External umbilical hose: 4 feet
(1219.2mm) PVC

Wire: 22AWG PVC jacket

O-rings: Buna-N

Color: Gray with gray hose

Terminations:

Panel: 1/16" (1.6mm) hose barb and
two 22AWG wires with 11" (279.4mm)
pigtail

Umbilical: 1/16" (1.6mm) ID PVC tube
and two 22AWG wires with 3" (76.2mm)
pigtail

Number of air lines: 1

Electrical Specifications

Voltage: Up to 24VDC

Current: Up to 3 Amps

Wire: 22AWG with PVC jacket

Number of contacts: 2

CONFIGURATION HOSE

FLOW PATH
1/16" ID (1.6mm)

PART NO.
MHQC17000

A
.62 (15.75mm)

B
2.00 (50.8mm)

Coupling Hose



CONFIGURATION PANEL MOUNT

FLOW PATH
1/16" ID (1.6mm)

PART NO.
MHQC42000

A
.825 (20.95mm)

B
.60 (15.24mm)

Coupling Panel



Visit us at www.colder.com/hybridmovie or scan the QR code with your smart phone to navigate directly to a web page where you can view the Hybrid Technology.



Colder Products Company®
Quick Couplings & Fittings for Plastic Tubing

CPC 西北地区签约经销商: 西安嘉岳自动化技术有限公司 Garye

Automation Company

地址: 西安市未央区经济技术开发区凤城五路 89 号 5 幢 1 单元 10601 室

手机: 18292561696 E-mail: sales@garye.cn

We inspire confidence at every point of connection.

WARRANTY: All sales are subject to Colder Products Company's limited express warranty set forth in the Colder catalog. Contact your local distributor or Colder Customer Service for warranty provisions.

Warning: Due to the wide variety of possible fluid media and operating conditions, unintended consequences may result from the use of this product, all of which are beyond the control of Colder. It is the user's responsibility to carefully determine and test for compatibility for use with their application. All such risks shall be assumed by the buyer.